

Technical data sheet



Washstands

WT.RX400.KE

Article number: 4506500000

Design partner: sieger design

Features

Description

Article number

Standard colour

Construction

Dimensions

Material

Net weight

Installation

Accessoires

WT.RX400.KE

4506500000

White

without tap hole, without overflow

ø 400 x 900mm

Glazed steel

20,5 kg

for wall connection

Mirror SP.300, Mirror SP.300.1, Mirror SP.325, Mirror SP.325.3, Design mirror SP.FR375.S1

Optimum point of impact approx. 147 – 192mm from rear edge of basin.

Tap fitting information

Tap fittings with a vertical outlet and aerator provide the optimum flow of water onto the surface below (angle of impact: 90°).

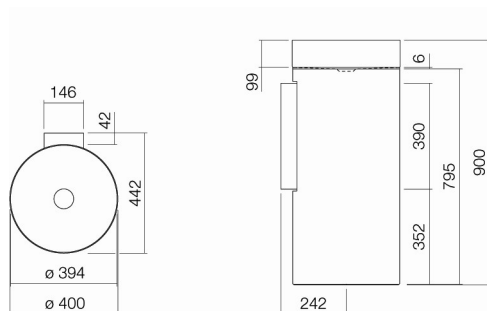

Text for invitation to tender

Washstand, round, ø 400mm, glazed inside and outside, white, height 900mm, without tap hole and overflow, including chrome-plated spacer ring between basin and column, drain valve with chrome-plated cap, fixing set and white wall bracket

Brand: Alape

Model: WT.RX400.KE

A³form

Technical data sheet