

A³form

Technical data sheet



Washplaces

WP.Insert5

Article number: 5245000110

Design partner: busalt design

Features

Description

Article number

Standard colour

Construction

Dimensions

Material

Net weight

Installation

Accessoires

Tap fitting information

Tap fittings with a vertical outlet and aerator provide the optimum flow of water onto the surface below (angle of impact: 90°).

WP.Insert5

5245000110

White / anthracite brown

without tap hole, without overflow

250 x 250 x 470mm

Glazed steel

7,35 kg

for wall connection

Mirror SP.300C, Mirror SP.300C.1

Optimum point of impact approx. 84 – 124mm from centre of tap hole.

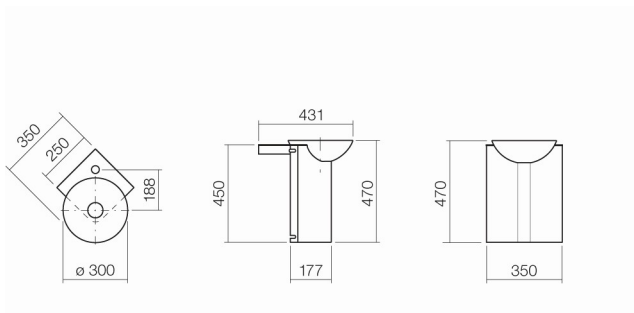

Text for invitation to tender

Corner washplace, 250 x 250mm, height 470mm, dish basin 300mm in white glazed steel, central, without overflow, base cabinet powder coated white, with tap hole, shelf in glazed steel anthracite brown, includes chrome-plated drain valve and fixing set

Brand: Alape

Model: WP.Insert5

A³form